

FOR CONTINUATION  
 SEE DRAWING NO. 0016

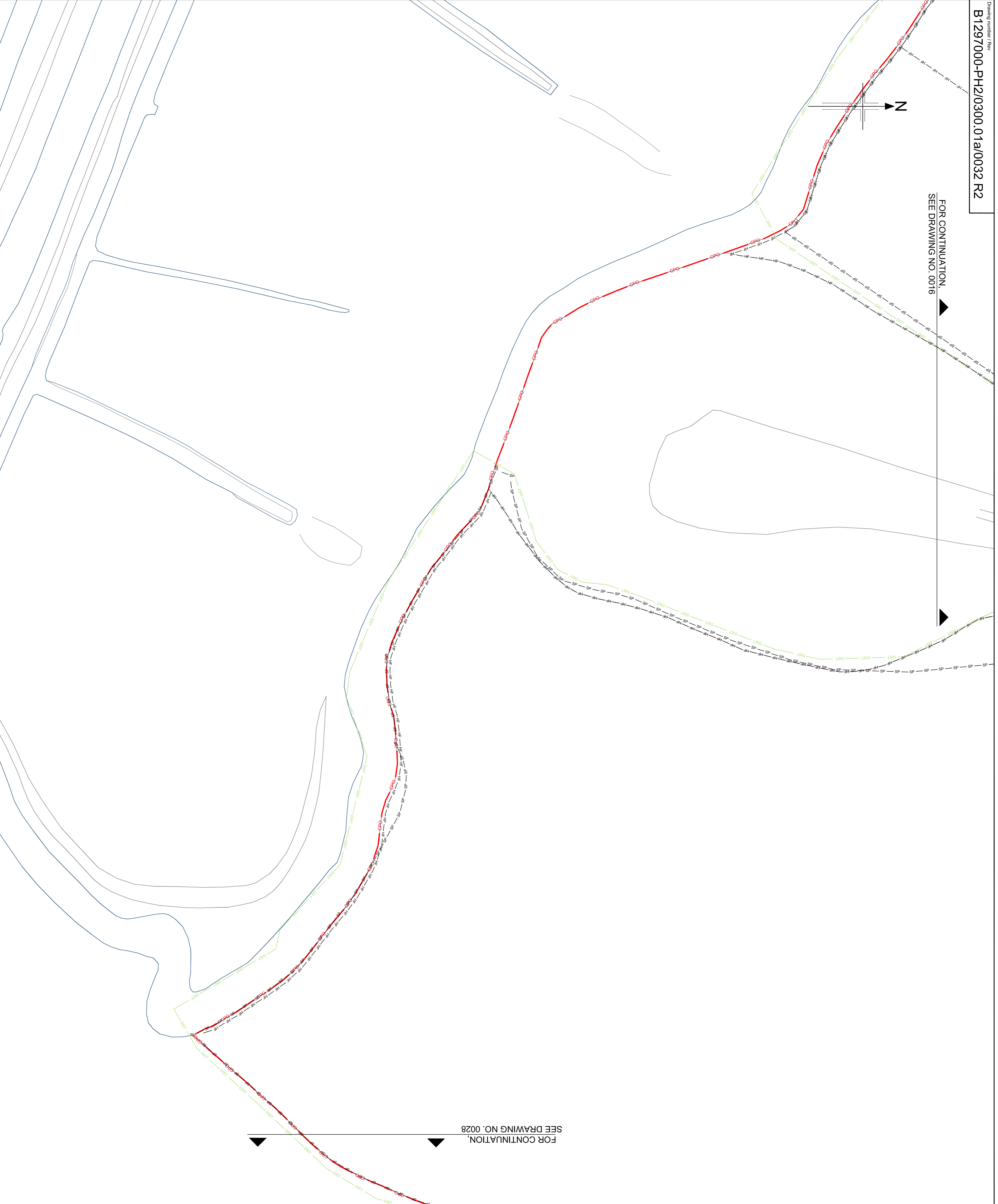

FOR CONTINUATION  
 SEE DRAWING NO. 0028

**NOTES**

1. Refer to drawing number B1297000/0300.01a/0000 for Key plan drawings are to be used in conjunction with Appendix
2. All Fencing, Gates and Sills
3. Stock Proof Fencing- It has been assumed that all Agricultural fencing requires stock proof fencing; this is to be reviewed following confirmation of land use/maintenance.
4. Gates- The location and provision of gates and sills are to be decided by the contractor in consultation with the client.
5. Noise Barrier to be placed on highway boundary or offset up to 1m inside highway boundary subject to agreement with adjacent landowners.
6. Noise Barrier- Close boarded timber noise attenuation barrier.
7. Badger gates- One way badger gates to be provided along the route of the link road at a minimum of 500m spacing on both side of the link road.
8. Badger proof fencing to taper towards mammal tunnel entrances.
9. Where stock proof / noise proof fencing and badger fencing are required in close proximity a design solution to combine fence types will be considered.

**KEY**

- CPC Boundary
- Standard timber post and Rail
- Stock Proof
- Badger Proof
- Stock/Badger Proof
- Bat Fence
- Temporary Fence
- Timber Post and Wire
- Absorptive Noise Barrier
- Reflective Noise Barrier (Height - 1.8m)
- Reflective Noise Barrier (Height - 1.5)
- Herpicide Fence
- Gate
- Badger Gate (2 way)
- Noise Bund
- Temporary Fencing SSSI

**SAFETY, HEALTH AND ENVIRONMENTAL INFORMATION**

In addition to the hazards normally associated with the work detailed on this drawing, note the following:

- CONSTRUCTION
- MAINTENANCE / CLEANING
- DECOMMISSIONING / DEMOLITION

It is assumed that all works will be carried out by a competent contractor working where appropriate, to an approved method statement.

Reproduction from the Ordnance Survey Map with the permission of the controller of Her Majesty's stationery office Crown copyright reserved Licence No. AL 100017326

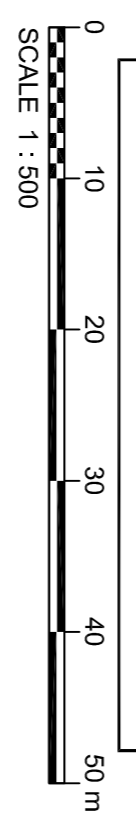

Rev	Rev. Date	Purpose of revision	Drawn	Checked	Rev'd	Approved
R2	14/12/2012	ISSUE FOR INFORMATION	DM	RS	SG	RD
R1	12/11/2012	ISSUE FOR INFORMATION	DM	RS	SG	RD
RO	02/11/2012	INITIAL ISSUE	DM	DM	RF	RD

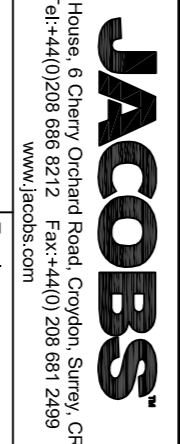

Simpson House, 6 Cherry Orchard Road, Gorton, Salford, Greater Manchester, M6 4JG  
 Tel: +44(0)2045 666 8212 Fax: +44(0)2045 666 2499  
 www.jacobs.com



Client: **HOCHTIEF TRAVLER**  
 Employer: **TRAVLER**  
 Project: **BEXHILL TO HASTINGS LINK ROAD**

Drawing title  
**FENCING**  
**SHEET 32 OF 32**

Drawing status  
**ISSUE FOR REVIEW**

Scale	1:500 @ A1	DO NOT SCALE
Jacobs No.	B1297000-PH2	
Client no.		
Drawing number	B1297000-PH2/0300.01a/0032	R2
Rev		

This drawing is not to be used in whole or part other than for the intended purpose and project as defined on this drawing. Refer to the contract for full terms and conditions.